

Brass Ball Valve

2 Piece • Full Port • Threaded Connections • 600 WOG



H100T

CRN# 0C16887.5469870YTN

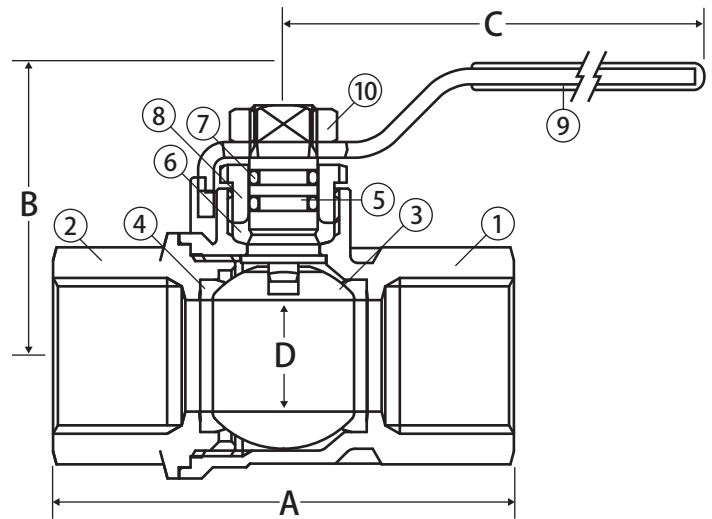

Features

- Blow-out proof stem
- Triple sealing stem with 2 Viton® o-rings and Teflon® seal
- 100% leak tested
- 100% Made in Italy
- Leakproof stem - Lifetime Warranty
- 29 in-HG vacuum rating

Approvals

- UL Listed (1/4" - 2")
 - VQGU - Trim & drain
 - MHKZ - Manual valves
 - YQNZ - Compressed gas shut-off valves
 - YRBX - Flammable liquid shut-off valves
 - YRPV - Gas shut-off valves
 - YSDT - LP gas shut-off valves
 - SFJQ - Valves, refrigerant
- CSA Certified
 - ANSI Z21.15 (.5 PSIG) (1/4" - 3")
 - ASME B16.33 (125 PSIG) (1/2" - 2")
 - ASME B16.38 (125PSIG) (2-1/2" - 4")
 - CGA 3.16 (125 PSI) (1/4" - 4")
 - CGA 9.2 (1/4" - 3")
 - Delta C (3/8" - 3/4")
- FM Approval (1/4" - 2")
- MSS SP-110
- ANSI B1.20.1

Material Specifications

No.	Part	Material
1	Body	Brass - CW617N
2	End Connection	Brass - CW617N
3	Ball	T.E.A. Coated Brass - CW617N
4	Seat (2)	Hostaflon® TFM 1600
5	Stem	Brass - CW614N
6	Packing	Hostaflon® TFM 1600
7	Stem O-ring (2)	Viton®
8	Packing Gland	Brass - CW614N
9	Handle	Steel - Geomet® Plated
10	Handle Nut	Steel - Geomet® Plated

Dimensions

Part No.	Size	A	B	C	D	Cv
H100-701	1/4"	1.86	1.41	2.95	0.39	7.66
H100-702	3/8"	1.86	1.41	2.95	0.39	7.77
H100-703	1/2"	2.45	1.53	2.95	0.59	16.82
H100-704	3/4"	2.71	1.95	3.74	0.79	34.80
H100-705	1"	3.30	2.40	4.75	0.97	52.20
H100-706	1-1/4"	3.80	2.59	4.75	1.23	112.52
H100-707	1-1/2"	4.16	3.22	6.00	1.49	174.00
H100-708	2"	5.00	3.40	6.00	1.99	255.20
H100-709	2 1/2"	6.06	4.60	8.00	2.46	350.32
H100-710	3"	7.08	4.90	8.00	2.99	563.76
H100-711	4"	8.57	5.90	9.88	4.00	879.28

Valve Seat Rating

1/4" - 3/4" 600 WOG, 1-2" 500 WOG, 2-1/2" - 4" 400 WOG - 150 WSP

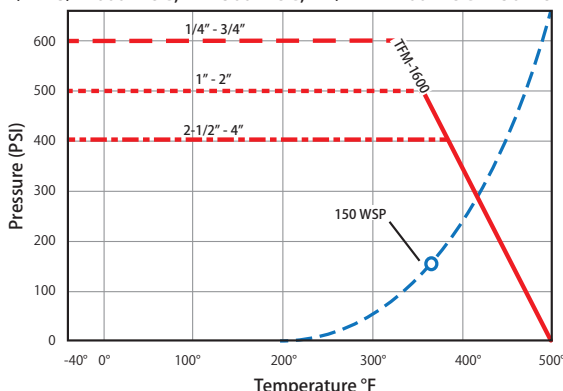

WARNING: This product can expose you to chemicals including lead, which is known to the State of California to cause cancer, and lead, which is known to the State of California to cause birth defects or other reproductive harm. For more information go to www.P65Warnings.ca.gov.